

# Elkhorn Middle School

3200 North 207<sup>th</sup> Plaza, Elkhorn, Nebraska 68022



July 31, 2017

Dear Students and Parents,

Welcome to the 2017-18 school year at Elkhorn Middle School! We hope all of you had an enjoyable and relaxing summer. We are projecting student enrollment this year to be at or around 460; just slightly larger than last year. For each of those students, we at Elkhorn Middle School have embraced a culture of continuous improvement; we seek ways to bring students to higher levels of achievement and are committed to making sure your student(s) demonstrate outstanding growth academically, socially, and emotionally. This year we welcome the following new staff members:

Christine Kluender – 6<sup>th</sup> & 7<sup>th</sup> Math and SS  
Jake Kment – 7<sup>th</sup> Science  
Laura Thoreen - HALE  
Axton Kahler – Art  
Julie Ermel - FCS  
Jesse Gardner - Health  
Jeff Maas - IT

Jennifer Latshaw - TA  
Meggie Widholm – P.E. TA  
Erin Jensen - TA  
Patti Tedford - Custodian  
New Accompanist TDB

One of our goals every year is to get you, the parents, involved in your child's education. Research will show that middle school is a critical time for parents to be involved and active in their child's life. The EMS Booster Club makes requests for parent volunteers throughout the year to assist with events such as the Back to School Dance or health screenings. The Elkhorn Public Schools also utilize adult volunteers as mentors through the Partners in Ed program. We are always grateful to the parents who choose to support the school in these ways.

## IMPORTANT DATES:

- Back to School 101 **August 10th 10:00am – 7:00pm**. All Elkhorn Middle School students should attend as school pictures will be taken. Visit the following website for pre-registration information and forms: [Back to School 101 Information](#)
- You may download the documents and complete them before you arrive to make your visit as efficient as possible.
- All students will receive an assignment book (agenda) during Back to School 101. The agenda is an organizational tool that will assist students on their way to success at Elkhorn Middle School. *One of the easiest and most effective ways to stay informed is to review your child's agenda with them on a nightly basis.* The Parent-Student Handbook, which outlines the rules and expectations, is also printed in the agenda.
- New Student Orientation will be Thursday, **August 10 at 6:00pm**. This is for all students and families new to the district. This will be an evening for you to familiarize yourself with the building, meet other new students, the administration and counseling staff.

- Open House/Curriculum night is scheduled for Monday, **August 14th** for all Middle School students and parents to meet teachers and learn about curriculum opportunities and team procedures.

### **FIRST DAY OF SCHOOL**

School for all students will begin on Thursday, **August 17th at 8:10 a.m.**

- Students who are **NEW** to Elkhorn Middle School can attend a new student breakfast in the library starting at 7:45.
- All **6<sup>th</sup> grade** students should report immediately to the gymnasium upon arrival to school the first day. Building tours, transitional activities and an extended lunch period will be a part of their orientation. If you feel your child needs additional time in the building prior to school starting, please give us a call to discuss those concerns.
- **Seventh and eighth grade** students are asked to wait outside the main doors (South entrance) until the 8:00am bell. Seventh and eighth graders will then report to their Hi 5 class.

The first day will function as a normal school day and will end at 3:20 p.m. Lunches will be served and buses will run. If you have questions about bus transportation, please call Chief School Bus service, (402) 392-2144 or Central Office, (402) 289-2579.

### **COMMUNICATION**

We work, as a staff, to ensure that students and parents are informed. Please note, and look for, the following venues of communication during the course of the year:

- Daily bulletin posted on the EMS website
- Newsletters every month – emailed via School Messenger and on the EMS website
- PowerSchool – online access to your child’s gradebook in each subject.
- Parent Booster Club – sign up opportunities will be at Pre-Registration and Open House.
- 4 ½ week progress reports sent home.
- 9 week report cards mailed home.
- Parent-Teacher conferences – fall and spring

The entire staff at EMS and I are committed to helping your child experience academic, social and emotional growth this year. With your support and involvement **your child will learn!** If you have any questions, at any time, don’t hesitate to call us at 289-2428.

Welcome to EMS for 2017-18!



Deb Garrison  
Principal

**\*\*PICK UP and DROP PATTERNS**

Drive NORTH on 207th Plaza (approaching the building from the south)  
Enter parking lot drive closest to the building  
Enter drop off loop by main entrance  
Exit parking lot through drive at the end of the parking lot  
Drive SOUTH on 207th Plaza

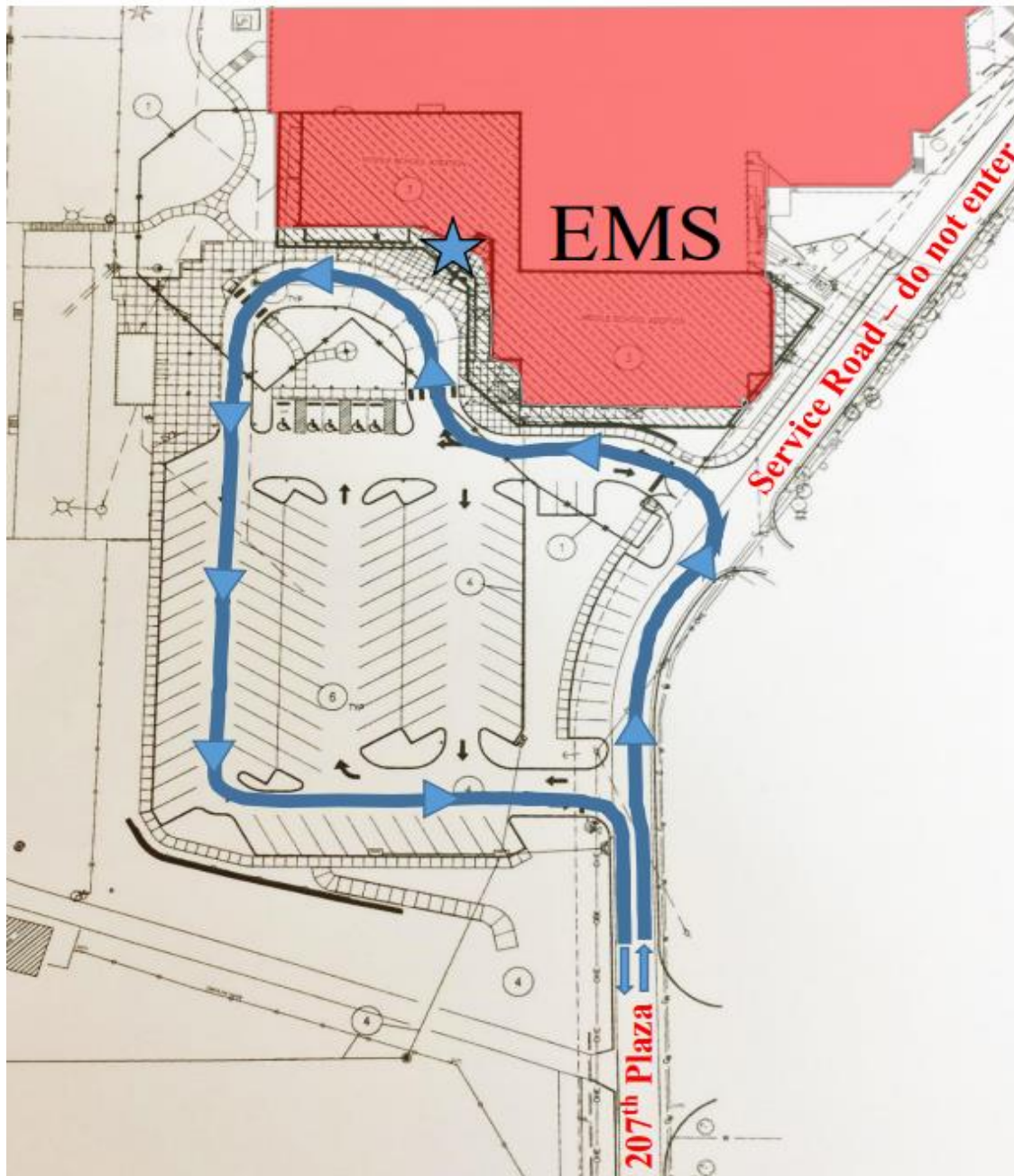

# BACK TO SCHOOL 101

## AUGUST 10, 2017 10:00 AM - 7:00 PM

Elkhorn Middle School will host a Pre-Registration day for all students before school starts.

**\*\*Access Forms On-Line\*\*** Please visit the Pre-Registration page on our website for blank forms and additional information that will save you time and will make pre-registration more efficient for everyone. [Back to School 101 Information](#)

Parents/Students will arrive and proceed through a series of stations:

- 1) Pick-up Student Information Cards and make any necessary changes
- 2) Pick-up Student Agenda/Handbook and sign release form
- 3) Optional: Prepay for Yearbook (\$30.00); Student Directory (Free)
- 4) EMS Booster Club Info and EMS Spirit Wear for 2017-18
- 5) Athletic Information/Athletic Physical Forms, Activity Pass (\$35.00 for students and \$55.00 for adults) — Seventh and eighth graders will need an activity pass if they will be participating in sports.
- 6) Lunch Accounts
- 7) School pictures (Picture packets are optional, school yearbook photo-no charge)
- 8) Health Update Forms, School Physicals, Immunizations
- 9) Return signed Student Information Card & Field Trip Permission Slip
- 10) Pick-up student schedule
- 11) Questions/answers

**\*\*Volunteers Needed\*\*** Elkhorn Middle School BACK TO SCHOOL 101 will be Thursday, August 10th, from 10am-7pm. We are looking for volunteers to work small segments of time for specific stations to make the parent and student back to school experience the BEST! The more volunteers, the more smoothly the day will go. Thank you in advance for volunteering some time on that day.

[www.SignUpGenius.com/go/4090F4EABA722AAFD0-emsback](http://www.SignUpGenius.com/go/4090F4EABA722AAFD0-emsback)

If you have any questions,, please call Mary Jo Giesselmann, at (402) 289-2428.

### SMILE!

School pictures will be taken during pre-registration. Please dress accordingly.



ELKHORN "CLASSIC" MIDDLE SCHOOL

# Open House

Monday, August 14, 2017

Come meet your child's teachers, hear about their classes, and tour EMS!!

Grade level teachers will be doing a large group presentation in the commons at the following times:

**6:30 p.m. 6<sup>th</sup> Grade Classroom Visits**

*\*Followed by a presentation at 7:00 pm*

**6:00 p.m. 7<sup>th</sup> Grade Classroom Visits**

*\*Followed by a presentation at 6:30 pm*

**6:00 p.m. 8<sup>th</sup> Grade Presentation**

*\*Followed by classroom visits at 6:30 pm*

*Hope to see you on the 14<sup>th</sup> !!*



As some of you may be aware, a total solar eclipse with 98% totality will be viewable in our community on Monday, August 21 from 11:30 a.m. – 2:20 p.m. This event will be both educational and historical for our students to witness, as an eclipse with this level of visibility has not occurred since 1918.

District science teachers and administrative staff have been busy preparing for the event by ordering special glasses for all students to be able to view the eclipse, as well as preparing learning materials and resources for staff to adequately engage students at all grade levels in this event. Some schedules will also be adjusted in order to allow for participation and viewing.

While all staff will be trained on safety measures to be taken in regards to protecting all students, there is a potential for retinal injury by viewing the eclipse directly, when done without the protection of the glasses. Due to this possibility, we are requiring positive parent permission for students to participate. If you have any questions or concerns regarding this event, please feel free to contact the school.

## The kids are heading back to school, how about you?

The Elkhorn Public School District is currently seeking teacher assistant/paraprofessionals in our early education, elementary, and secondary settings. EPS is seeking caring and collaborative individuals with a desire to help students achieve.

Family friendly hours – follows the school day and calendar

Competitive pay (\$13.75/\$14.25)

Rewarding working environment

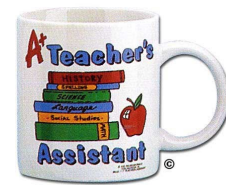

Apply at [www.elkhornweb.org](http://www.elkhornweb.org) Employment: Support Staff Non-Certified: Teacher Assistant

---

### From the Nurse...

Welcome back, I hope you had a great summer! We want to keep your student(s) happy, healthy, and safe while at school, so please read the following information carefully.

#### ~ Sick Child Policy ~

Please remember if your student is running a fever of  $>100.0$  or has vomiting/diarrhea, please keep them home from school until fever or vomiting free for 24 hours, without the aid of medication (Motrin, Tylenol, Advil, acetaminophen, ibuprofen).

#### ~ Physical and Immunization Requirements ~

Nebraska law requires that all school children have a **physical examination** upon entry into school, at seventh grade, and when transferring from an out-of-state school. Students must provide proof of a **visual evaluation** to include testing for amblyopia, strabismus, internal and external eye health and visual acuity upon entry into school and when transferring from an out-of-state school. The law also requires your child be immunized and provide **proof of immunization** before attending classes. Please visit the Nebraska Department of Health and Human Services (link below) which outlines specific vaccine requirements.

Link to DHHS vaccine summary for 2017-2018:

<http://dhhs.ne.gov/publichealth/Immunization/Documents/2017-2018%20School%20RR%20English.pdf>

#### ~ Medication for the 2017-2018 School Year ~

If your student requires any medication (over-the-counter and/or prescription) while at school, each medication must have a Medication Authorization form (link below) signed by the parent and a physician, before we can administer. All medications must be unexpired and provided in the original packaging and/or pharmacy container. For prescription medication, please only provide a **maximum of 30 day supply** at a time.

***All medication must be dropped off in the office by a parent or guardian.***

***Please do not send any medications with your student.***

Link to print blank medication authorization form:

<http://www.elkhornweb.org/parents/student-medication-form/>

#### ~ Students with Asthma, Severe Allergies, Diabetes, and/or Seizures ~

If your child has asthma, severe allergies, diabetes, and/or seizures, please submit an emergency action plan signed by your physician. ***Plans must be updated annually.*** Blank forms can be obtained at the school office, or your physician's office can use whichever form they prefer.





# Elkhorn Public Schools

## MIDDLE SCHOOL Supply List

Elkhorn MS, Elkhorn Grandview MS, Elkhorn Ridge MS, Elkhorn Valley View MS

The following student supply list is provided to assist you this summer and early fall to prepare for the school year. Students are encouraged, but not required, to bring the following school supplies. Please note this is a year round list to be kept throughout the year.

### **6<sup>th</sup> Grade**

#2 Pencils  
Erasers  
Blue or black pens  
Red pen  
Markers  
Highlighters  
Colored pencils  
Dry erase markers  
Glue Sticks  
Loose-leaf paper  
(4) Single-subject notebooks  
(1) Composition notebook  
Index cards  
(3) boxes of tissues  
(1) 2" three-ring binder  
5 tab dividers  
Trapper with (7) 2 pocket folders or accordion file  
Inexpensive ear buds

### **7<sup>th</sup> Grade**

#2 pencils  
Erasers  
Blue or Black pens  
Red pen  
Markers  
Highlighters  
Colored pencils  
Dry erase markers  
Glue Sticks  
Loose-leaf paper  
(College ruled)  
(6) Single subject notebooks  
(2) Composition notebook  
Calculator (w/ fraction key)  
Index cards  
(3) boxes of tissue  
(1) 1" 3-ring binder  
Organizational system  
(folders or trapper)  
Inexpensive earbuds

### **8<sup>th</sup> Grade**

#2 pencils  
Blue or black pens  
Red pen  
Highlighters  
Colored pencils  
Dry erase markers  
Glue Sticks  
Loose-leaf paper  
(College ruled)  
(6) 2 Pocket folders  
(6) Separate spiral notebooks  
(2) Composition notebooks  
Calculator (w/fraction key)  
Index cards  
(3) boxes of tissue  
(1) 2" 3-ring binder  
Optional organizational system (folders or trapper)  
Inexpensive earbuds

**Band and Chorus Students:** Music Department T-shirt (\$10.00), black slacks, black socks, black shoes.

**P.E. Students:** Tennis shoes, t-shirts, and shorts.

**Spanish Students:** Spiral notebook, 2 pocket folder, blue or black pens, Index cards.

I WANT TO  
**VOLUNTEER**  
Elkhorn MIDDLE SCHOOL  
BOOSTER CLUB

NAME \_\_\_\_\_

PHONE (H) \_\_\_\_\_ (C) \_\_\_\_\_

EMAIL \_\_\_\_\_

\_\_\_\_\_ just Keep me in the loop with info

\_\_\_\_\_ call or email me for anything

\_\_\_\_\_ box tops

\_\_\_\_\_ concession stand volunteer

Be a part of our concession stand pool of volunteers. Work only your choice of EMS home games. No experience necessary!

\_\_\_\_\_ conference meals for teachers/staff

Donate Food and/or \$10 donation (OCT and FEB)

\_\_\_\_\_ dance chaperone/ Volunteer

Back to School dance for all grades (Friday in September)

\_\_\_\_\_ health screening

(2 hours) Assist nurse with measuring height, weight, vision, & hearing (October)

\_\_\_\_\_ holiday hurrah

Holiday donation drive, package gifts for teachers/staff, and a festive luncheon (December)

\_\_\_\_\_ scholarship committee

Reading and evaluating high school student applications to win the EMS \$500 scholarship

\_\_\_\_\_ teacher/staff birthdays

\_\_\_\_\_ teacher/staff appreciation week (May 2018)

Help committee to recognize teacher/staff birthdays and/or teacher appreciation week